

FLEETWOOD TOWN CHRISTMAS FESTIVALS 2019

AGE SPECIFIC EVENTS FROM U7s TO U12s

PREMIER LEAGUE PITCHES TO PLAY ON / MAXIMUM GAME TIME – OPPORTUNITY FOR ‘PLAY’ TIME

Check our website for all further information – www.poolfootfarm.co.uk



GENERAL RULES & EVENT INFORMATION

- Registration will commence for all teams at 9am and should be completed by 9:45am
- All teams entering the tournament must be ready to start the event for the 1st KO at 10:00am.
- The referee's decision is final in all games.
- Any child suffering an illness or disability must be identified on the registration form.
- Managers will be responsible for the conduct of the team players and parents and supporters.
- Any players or spectators may be asked to leave the field of play or tournament grounds for the use of foul language, abusive or offensive behaviour towards any other person/s. Failure to comply with this rule may lead to the expulsion of the team they are playing for or supporting.
- Any issues that are not covered by these rules will be dealt with by the Poolfoot MANAGEMENT, whose say will be final in all instances.
- Poolfoot farm will not be responsible for the loss or damage to personal items, belongings and valuables. Please do not leave any items unattended.
- In most part all official FA rules will apply except some exceptions which are detailed under each age group rule section on the following pages.
- Strictly no alcohol to be brought onto the pitches from the bar or consumed by any persons at this event outside of the designated areas.



Rules for Competition(s)

- A) FA mini-football rules will apply
- B) Squads will consist of unlimited numbers as the discretion of the coach/manager of that team.
- C) Players must be in their respective age band from (season 2018/19 age groups June Festivals + Season 2019/201 age groups July Festivals)
- D) Formats - 5-a-side (U7s / U8s - On 4G) and 7-a-side (U9s / U10s – On 4G) 9-a-side (U11s / U12s – On 4G)

GAME TIMES:

- In accordance with the FA RULES ON MINI SOCCER the maximum amount of time a team can play in 5 a side is 60 mins. These age groups match times will reflect that in order to stay within the rules of the governing body.
 - U9s & 10s – matches will be 12 minutes – no half time (if group sizes are larger than 4, this will be reduced to ensure we adhere to the max participation time for this age group.
 - U11s, 12s will be dependent on entries, but be assured, game time will be maximised, and waiting time minimum – no half time unless weather has a significant effect on the direction of play.
- e) All substitutes are unlimited in each game.
 - f) The team that wins the toss will kick off.
 - g) The team that loses the toss will choose ends.
 - h) Scores will be collected in order to create a table format throughout the event.
 - i) The home team will provide the match ball

PARKING

- There will be limited parking 'on site' so we encourage that where possible, maximise car share opportunities within your team.
- Parking will be £5 for a full weekends pack.
- The facility has a surrounding neighbourhood which is sensitive to the traffic within it, please show a great deal of safety and respect when making your way to the venue. If you do park off site, ensure that you park responsibly as so not to restrict access or block other road users or residents.
- There will be an opportunity to use an overflow car park close to the facility, details will be sent to you in due course as to where this will be located.

FACILITIES

- There will be toilets, changing rooms and rest areas for players, coaches & supporters.
- We will have food available in the bar and through mobile units.
- There will be additional concessionary activities for visitors to take part in to add a smile to the day.
- There will be exclusive use of the 3g pitch for the U7 – U10 events. The 9 a side and 11 a side events will be a combination of GRASS & AstroTurf for the events, players should ensure they have footwear for these surfaces.



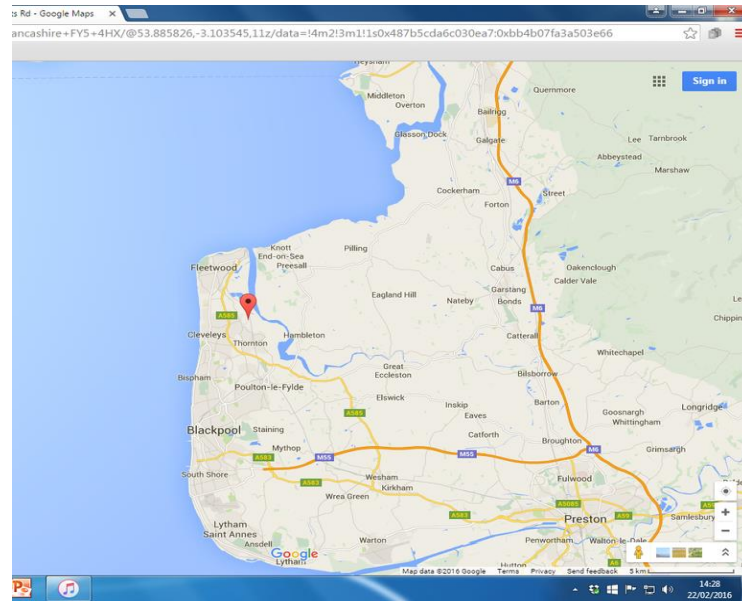

LOCATION

POOLFOOT FARM POST CODE IS FY5 4HX, AND LOCATED IN THORNTON, 10 MILES FROM BLACKPOOL – WHEN APPROACHING FROM PRESTON FOLLOW INFO BELOW

- Drive along M55. Take exit 3 from M55 9 min (9.6 mi)
- Follow A585 and Fleetwood Rd S/B5268 to your destination 19 min (9.0 mi)
- At the roundabout, take the 3rd exit onto Fleetwood Rd/A585 3.4 mi
- Use the left 2 lanes to turn left onto Garstang New Rd/A585
- Continue to follow A585 2.6 mi
- At the roundabout, take the 2nd exit onto Amounderness Way/A585 1.2 mi
- At the roundabout, take the 4th exit onto Fleetwood Rd S/B5268 1.3 mi
- Turn right onto Trunnah Rd/B5439 - 449 ft
- Turn left onto Heys St – FOLLOW RD AROUND TO THE LEFT WHICH BECOMES BUTTS RD AND THE COMPLEX IS ON YOUR LEFT HAND SIDE



MAIN CLUB SPONSOR



ENGLISH FOOTBALL LEAGUE SPONSOR



OFFICIAL BREWING PARTNER



OFFICIAL KIT PARTNER

FLEETWOOD TOWN FOOTBALL CLUB



HIGHBURY STADIUM | PARK AVENUE | FLEETWOOD | LANCASHIRE | FY7 6TX

FLEETWOODTOWNFC.COM | INFO@FLEETWOODTOWNFC.COM
GENERAL ENQUIRES: 01253 775080



MAIN CLUB SPONSOR



ENGLISH FOOTBALL LEAGUE SPONSOR



OFFICIAL BREWING PARTNER



OFFICIAL KIT PARTNER

FLEETWOOD TOWN FOOTBALL CLUB



HIGHBURY STADIUM | PARK AVENUE | FLEETWOOD | LANCASHIRE | FY7 6TX

FLEETWOODTOWNFC.COM | INFO@FLEETWOODTOWNFC.COM
GENERAL ENQUIRES: 01253 775080

Site Map

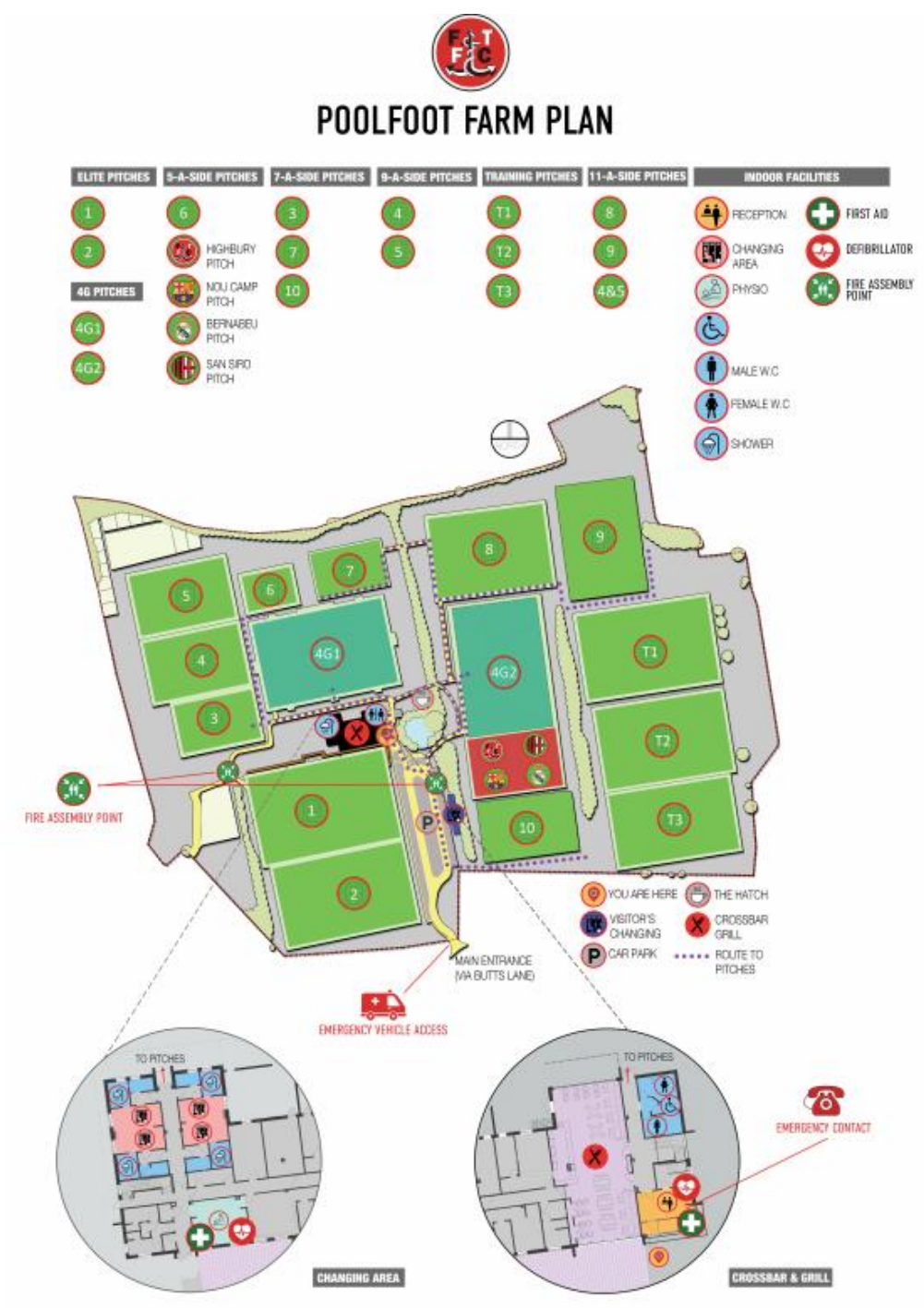

FLEETWOOD TOWN FOOTBALL CLUB IS THE TRADING NAME OF FLEETWOOD WANDERERS LIMITED, REGISTERED IN ENGLAND. COMPANY NUMBER: 03359117 WHOSE REGISTERED OFFICE IS 17 ST PETER'S PLACE, FLEETWOOD, LANCASHIRE, FY7 6EB.